

FIELD INSPECTION REPORT

Project Name:	Mountain Valley Pipeline	Inspector:	Marshall Willis
Inspection Date:	Thursday, October 20, 2022	Project Contact:	Brian Clauto, Cory Chalmers
Spread H: Franklin County	STA 13115+95 – 13141+53 MVP-FR-292/291	Weather:	Dry

ACTIVE STAGE OF CONSTRUCTION: (Check all that apply)

- ☐ Tree Felling
 ☐ Clearing/Grubbing
 ☐ Grading
 ☐ Trenching
 ☐ Stringing/Welding
☐ Lowering/Backfilling
 ☐ Final Restoration
 ☐ Temp. Stabilization
 ☐ Perm. Stabilization
 ☒ Dormant

- | | | Yes | No | N/A |
|----|---|-------------------------------------|-------------------------------------|--------------------------|
| 1. | Are controls installed and implemented in accordance with the approved erosion and sediment control plan and stormwater management plans? | <input checked="" type="checkbox"/> | <input type="checkbox"/> | <input type="checkbox"/> |
| 2. | Are all control measures properly maintained in effective operating condition in accordance with good engineering practices and, where applicable, manufacturer specifications? | <input checked="" type="checkbox"/> | <input type="checkbox"/> | <input type="checkbox"/> |
| 3. | Areas of offsite sediment deposition observed? | <input type="checkbox"/> | <input checked="" type="checkbox"/> | <input type="checkbox"/> |

Comments: Inspected the following resources: S-D17.

Recommended Corrective Action: N/A

Deadline: N/A

The recommended corrective action deadline date applies to all conditions noted on this report unless otherwise noted. If listed condition(s) currently constitute non-compliance and/or corrective actions are not completed by the deadline, other enforcement actions may be issued to the entity responsible for ensuring compliance on the above project.

Inspector Signature:



Date: Thursday, October 20, 2022

FIELD INSPECTION PHOTO LOG

Project Name: Mountain Valley Pipeline

Date: Thursday, October 20, 2022

Figure 1: STA 13118+00 – Controls in place and functioning properly.



Figure 2: STA 13125+00 – Controls in place and functioning properly.

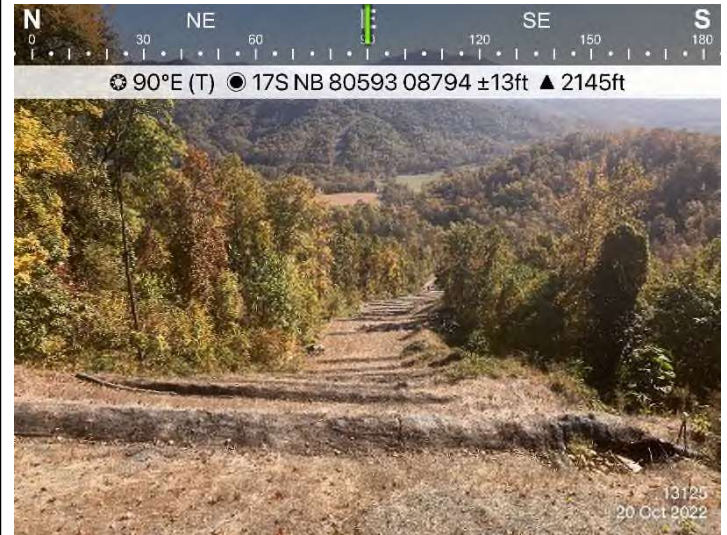

Figure 3: STA 13130+00 – Controls in place and functioning properly.

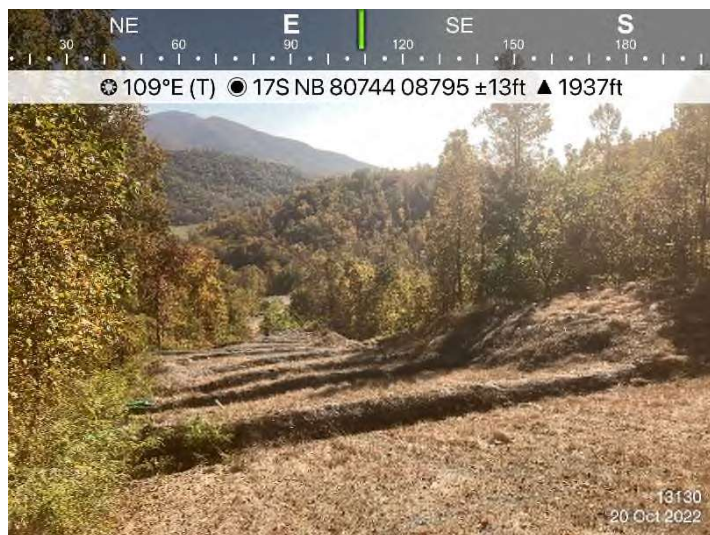

Figure 4: STA 13143+00 – Controls in place and functioning properly.

